

AMIKA

GELATO DISPLAY

Project:
Quantity:

Item:



Finish Options:

Okite- quartz based granite, RAL color system, ALPI wood laminates, Arpa laminates.



Optional Features:

- Operator side night curtain
- Casters
- Dipper well
- Stainless steel cake display insert
- Remote condensing unit

Standard Features:

- Flavor labels with back lighting
- Fan ventilated refrigeration system with double finned evaporator
- Auto reverse defrost cycle
- Digital control panel
- Tempered lift up front glass
- Polished aluminum profiles
- Sliding plexiglass doors
- LED lighting



AG ADVANCED GOURMET EQUIPMENT & DESIGN

Street: 5C Wendy Ct, Greensboro, NC 27409
Mail: PO Box 18542, Greensboro, NC 27419
P: 336.856.2919 F: 336.217.8838

Sales@AdvancedGourmet.com
AdvancedGourmet.com
PacojetUS.com AdvancedGourmetDisplays.com

AMIKA

GELATO DISPLAY

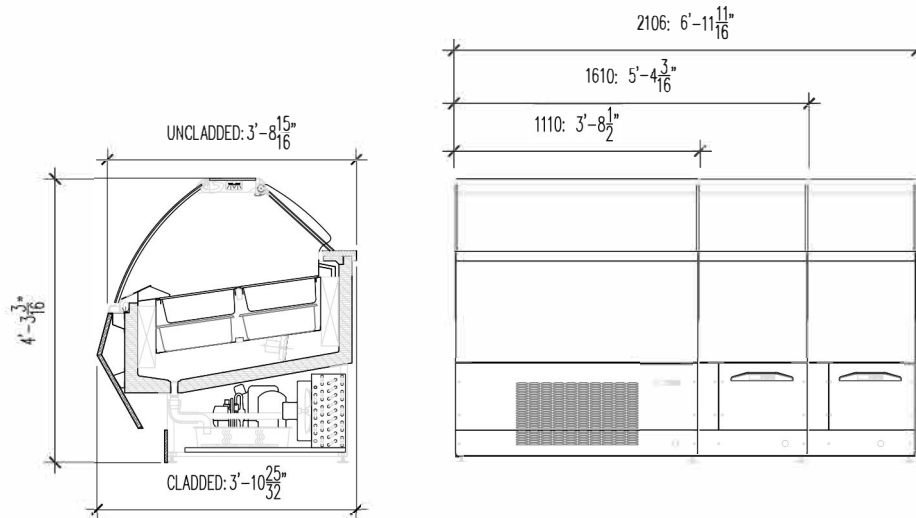

TECHNICAL FEATURE		VERSIONS			
		1100	1610	2106	2106 Double Temp.
External dimensions (L-D-H)	inches	44-1/2" x 44-15/16" x 51-3/16"	64-3/16" x 44-15/16" x 51-3/16"	83-11/16" x 44-15/16" x 51-3/16"	83-11/16" x 44-15/16" x 51-3/16"
Crated dimensions (L-D-H)	inches	51" x 51" x 58"	71" x 51" x 58"	91" x 51" x 58"	91" x 51" x 58"
Pans layout 5,2 Lt / mm. 360x165x120h 14 1/8" - 6 1/2" - 4 3/4"	flavors nr. / configuration	12	18	24	24 (12+12)
Pans layout 5,2 Lt / mm. 360x250x80h 14 1/8" - 10" - 3 1/8"	flavors nr. / configuration	8	12	16	16 (8+8)
Refrigeration	Type	Fan Ventilated	Fan Ventilated	Fan Ventilated	Fan Ventilated
Refrigerated display area	Type	Deck	Deck	Deck	Deck
Operating temperature	°C / °F	-18 / -0.4	-18 / -0.4	-18 / -0.4	-18 / -0.4
Compressor	nr. / Type	1 / semihermetic	1 / semihermetic	1 / semihermetic	2 / semihermetic
Cooling power *	(W)	800	1130	1440	800+800
Electric supply	(V/ph/Hz)	400/3/50+N (UE) 230-208/3/60 (USA)	400/3/50+N (UE) 230-208/3/60 (USA)	400/3/50+N (UE) 230-208/3/60 (USA)	400/3/50+N (UE) 230-208/3/60 (USA)
Power consumption	(W/A)	1950/5,2	3030/8,4	3620/9,4	3700/9,4
Defrost	Mode / type	reverse cycle	reverse cycle	reverse cycle	reverse cycle
Climatic class	N°°C/F°/H.R.	4+ / 35/95/70%	4+ / 35/95/70%	4+ / 35/95/70%	4+ / 35/95/70%
Refrigerant Gas	Type	R404A	R404A	R404A	R404A
Net weight	Kg / Lb	245 / 540	312 / 687	390 / 359	405 / 892
Crated weight	Kg / Lb	355 / 782	462 / 1081	575 / 1267	590 / 1300

* Installation of electrical to be completed by contracted electrician

* Machines do not come with cord or plug and require proper connection within the guidelines of local area

* Actual finished dimensioned to be taken only from CAD drawings provided by Advanced Gourmet

* Contact Advanced Gourmet for CAD files

AG ADVANCED GOURMET
EQUIPMENT & DESIGN

United States Importer of:

